



2040 Steel Drive, Suite E, Tucker, GA

Opportunity

- 7,760 sf available
- 945 sf office space
- 57,457 total building size
- 20' clear height
- 28' x 26' bay size
- Doors – 2 (10'x10') DH , 1 Ramp

Location

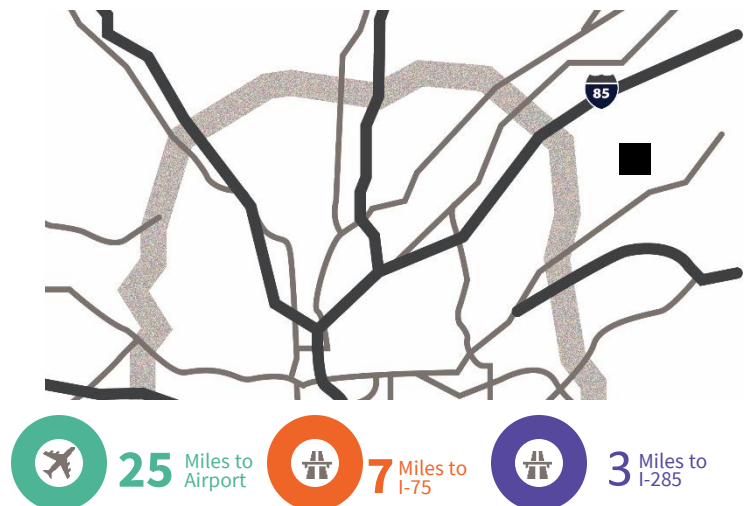

**For further
information**

Ben Parker, SIOR
Senior Vice President
+1 404 409 5678

avisonyoung.com

Industrial For Lease

Steel Drive / 2040 Steel Drive, Suite E, Tucker, GA

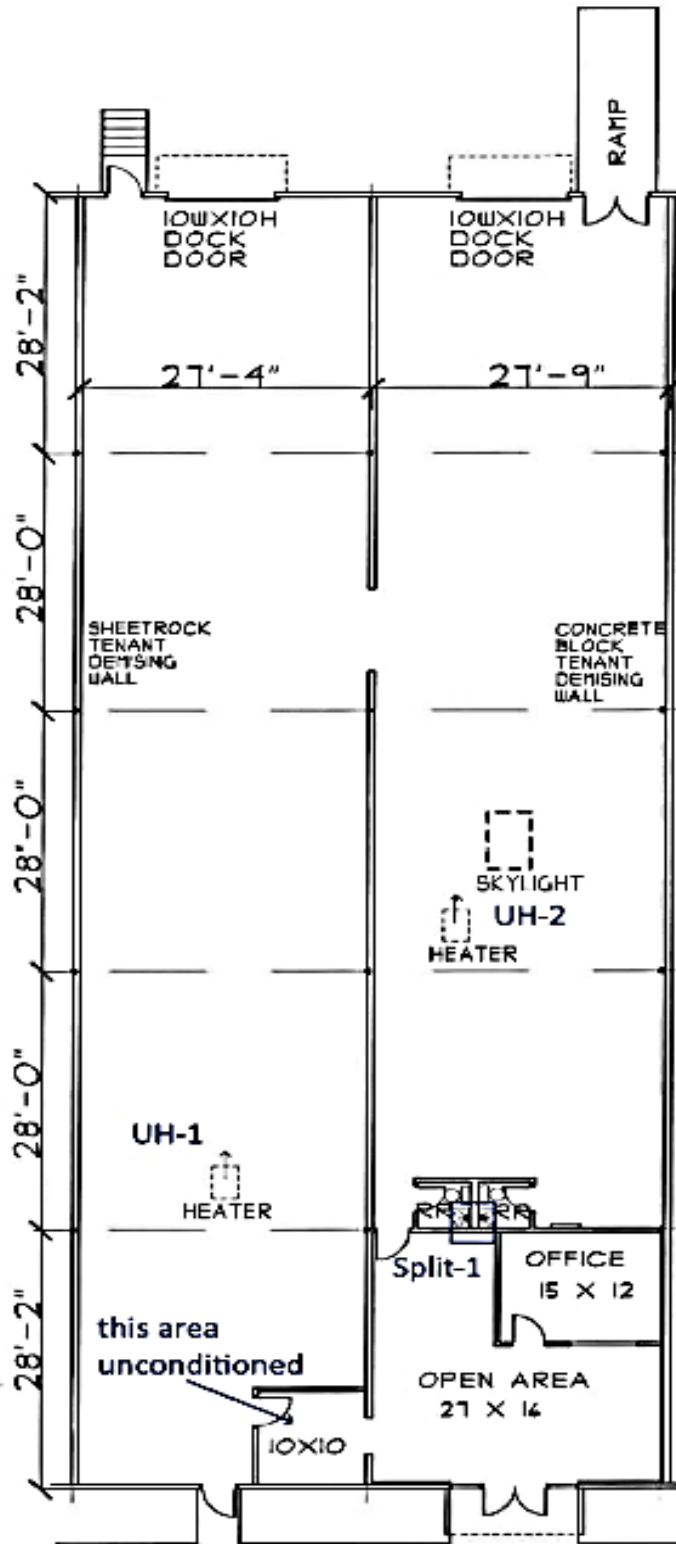

For further information

**AVISON
YOUNG**

Ben Parker, SIOR
Senior Vice President
+1 404 409 5678
ben.parker@avisonyoung.com

Owned by:

